

# BOARD OF SUPERVISORS

Madison County, Mississippi

E-911 Administration Office

146 W. Center Street, Room 203, PO Box 608, Canton, MS 39046

T: (601) 859-6485 F: (601) 859-4743

Date: July 2, 2014

To: Madison County Board of Supervisors

From: Butch Hammack



Re: Acceptance of New Road Names  
Livingston Township

Our office is making the recommendation to accept and add the following road names to the Madison County Road Registry. These roads will be located within the Livingston Township in Flora. We ask the Board to accept these roads as private roads.

Market Street  
Old Cedars Lane  
Spring Lake Lane

I have attached the documents for your viewing from the Developer requesting approval.

**Livingston Holdings, LLC    Town of Livingston**

601 Crescent BLVD, Ridgeland, MS 39157  
(601) 898-0212 (p) : (601) 898-0282 (f)

July 1, 2005

Administrative Assistant  
Jennifer Carpenter  
Madison County Board of Supervisors  
E-911 Administration  
125 West North Street  
Canton, MS 39046

---

Jennifer Carpenter

The Town of Livingston development on the corner of MS Hwy 22 and MS Hwy 463 is beginning our internal roadway construction. I have attached a copy of an already approved PUD site plan of our project that highlights three private drives that we will be constructing.

This letter is a request to name the three private drives:

- Market Street
- Old Cedars Lane
- Spring Lake Lane

Please review the attachment mapping these names for approval.

Regards

Richard Butler  
Town of Livingston  
Project Manager  
(601) 624-6876  
richardb8432@gmail.com

Attachment

# LIVINGSTON TOWNSHIP GENERAL DEVELOPMENT PLAN

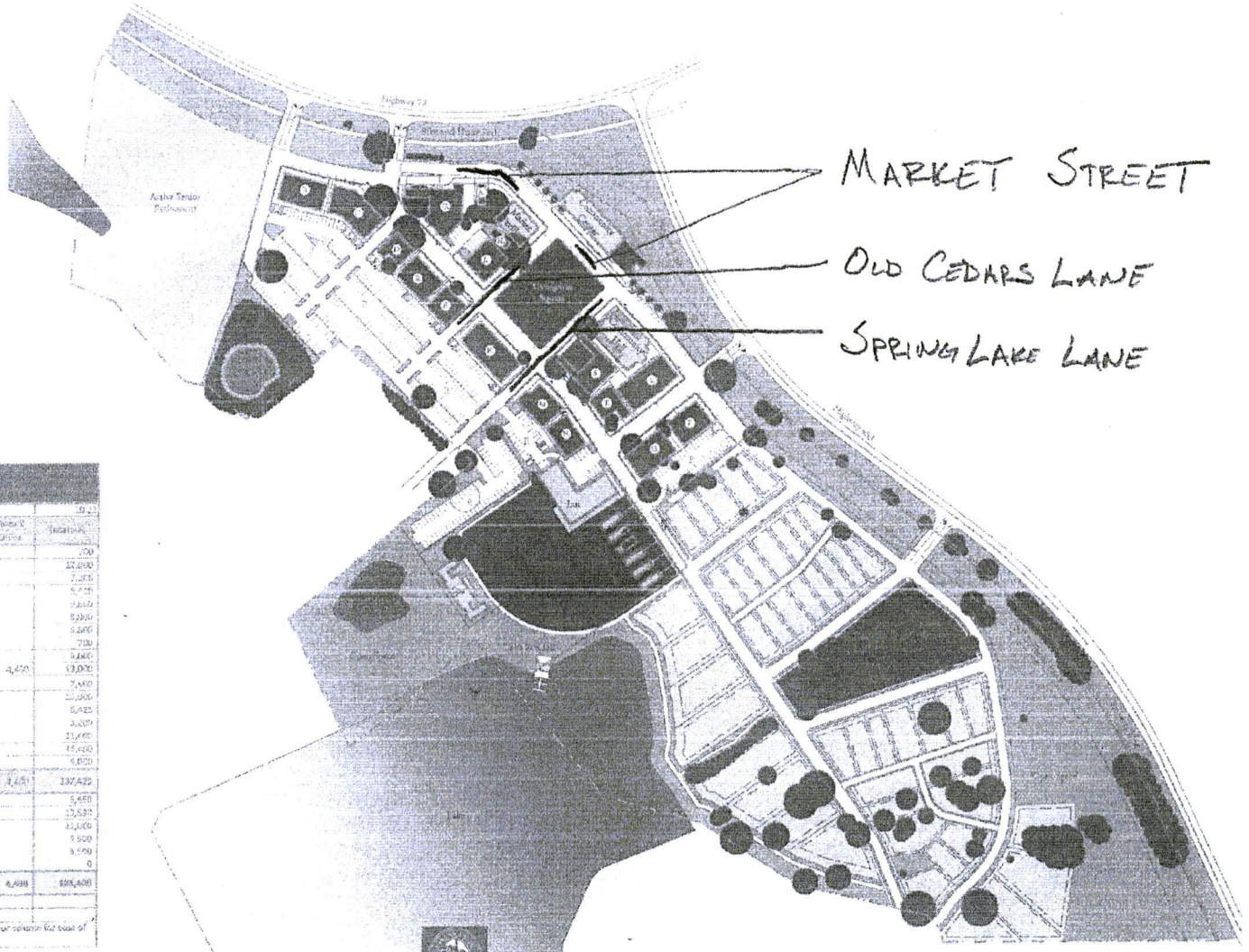

LIVINGSTON TOWNSHIP Commercial Square Footage						
Block	Commercial	Office	Office	Office	Office	Total
A	0	0	0	0	0	0
B	1	2,500	3,000	6,000		11,500
C	2	7,000				7,000
D			2,000	3,000		5,000
E	2	5,000		5,000		10,000
F	1	4,500	6,000	4,000		14,500
G	4	8,500		300		8,800
H	1	700				700
I	2	4,000		4,000		8,000
J	8	9,700	3,000	7,500	4,500	24,700
K	2	3,700	3,700			7,400
L	2	3,000		3,000		6,000
M	1	5,150		3,775		8,925
N	1	3,000				3,000
O	2	5,700		5,700		11,400
P	6	7,000		7,000		14,000
Q	1	4,000				4,000
<b>Total</b>	<b>60,241</b>	<b>15,500</b>	<b>43,000</b>	<b>14,500</b>		<b>137,241</b>
Office - 1st fl.	1	1,500				1,500
Office - 2nd fl.	2	7,457		2,073		9,530
Off.	4	5,500	4,000	10,000		19,500
Off.	1	4,500				4,500
Penetration	5	3,500				3,500
<b>Total Commercial S.F.</b>	<b>85,857</b>	<b>20,957</b>	<b>57,448</b>	<b>4,400</b>		<b>168,662</b>

[1] Restaurants to be located on second floor, but placed in the first floor column for ease of calculation.

